

S.NO	CATALOG NUMBER	ENCLOSURE OPTIONS
1	LPTE22-750	ALUMINUM BUS BARS AND CABINETS
2	LPTE22-750C	PLASTISOL COVERS FOR BUS BARS
3	LPTE22-750LI	LAY IN BUS BARS

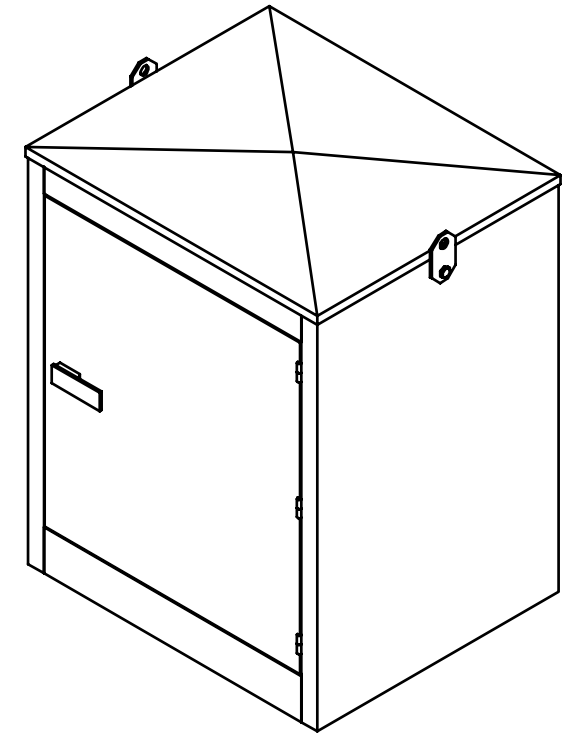
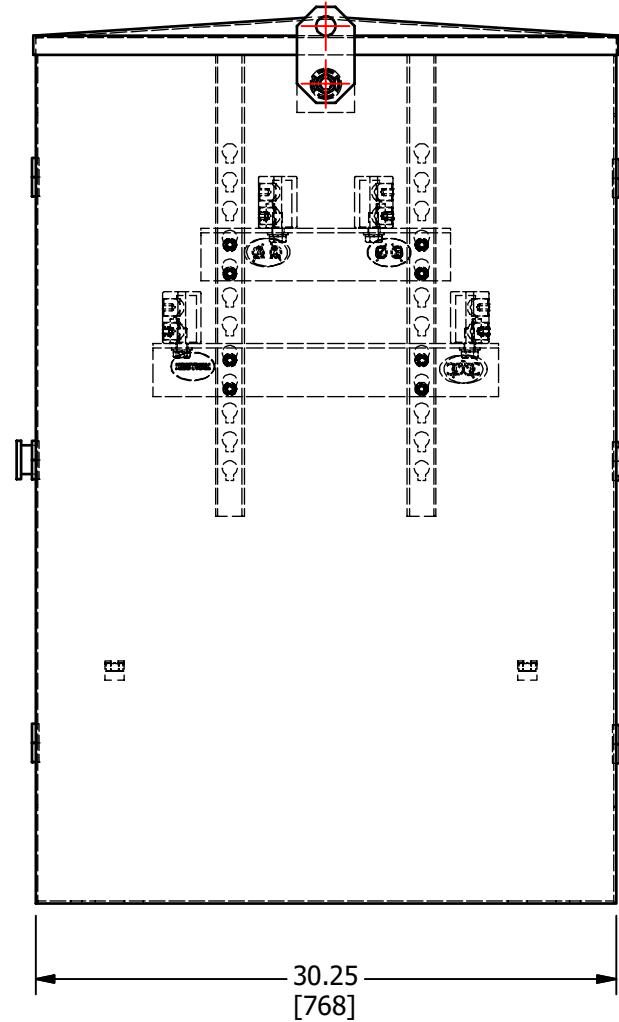
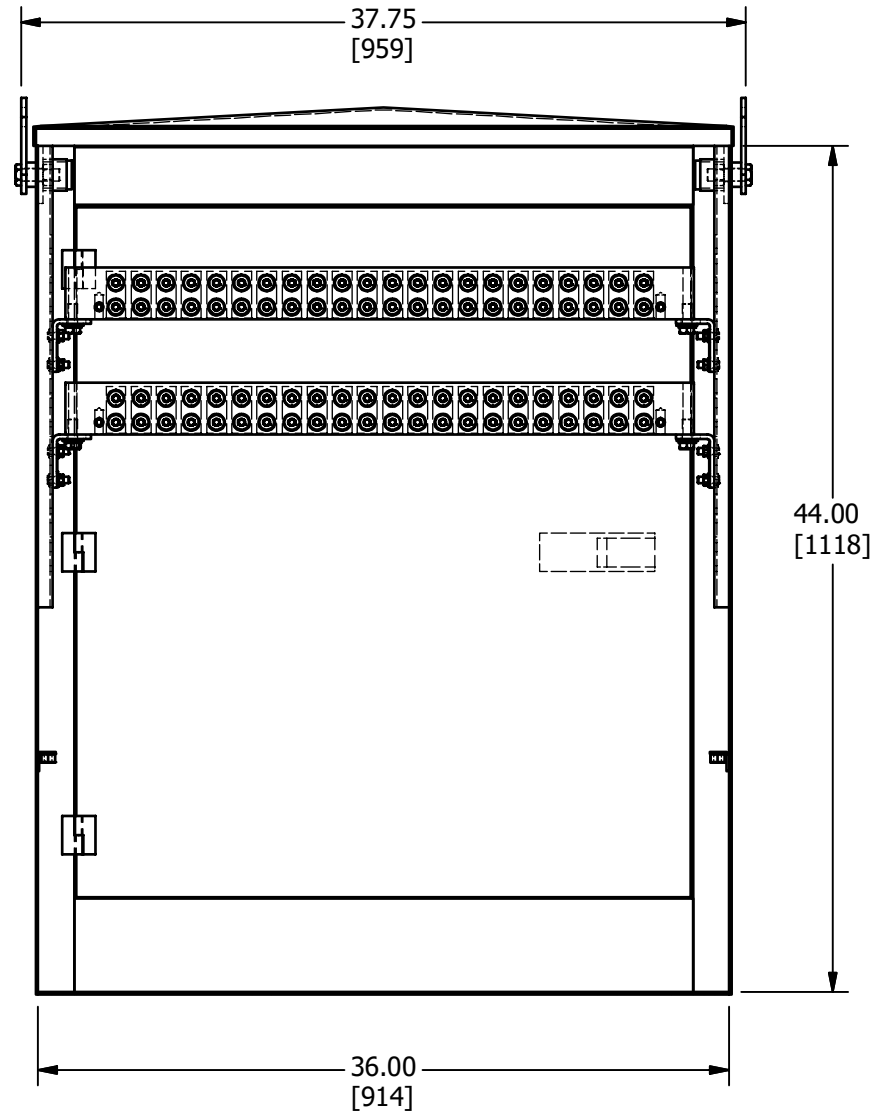

MATERIAL
ENCLOSURE: ALUMINUM
CONNECTORS: ALUMINUM

AMPERAGE RATING
5200 (COPPER WIRE)
4235 (ALUMINUM WIRE)

CONDUCTOR RANGE
750KCMIL-2

NUMBER OF CONDUCTORS: 22
CERTIFICATION: UL

						DRAWN BY: TS 04-30-19 CHECKED BY:	NAME OF PART: UL ENCLOSURE ASSEMBLY DWG NO: U22700005-S (CHARTED)	CAT. NO.: SEE TABLE
A	NEW DRAWING CREATED		04-30-19	TS	FOR PRODUCT INFO: http://www.cmclugs.com	DRAWING NOT TO SCALE		SHEET NO: 1 OF 1
REV.	DESCRIPTION	ECN	DATE	INIT.				

THIS INFORMATION IS PROPRIETARY TO CONNECTOR MFG. CO. AND IS NOT TO BE DISCLOSED OUTSIDE OF CONNECTOR MFG. CO. WITHOUT A CONFIDENTIALITY AGREEMENT



CONNECTOR MANUFACTURING CO.

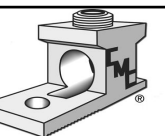

HAMILTON, OHIO